

LPD-0.005/1-2S

Power Divider

Specifications

- Frequency Range: 5~1000MHz
- Insertion Loss: ≤ 1.2 dB
- Amplitude Balance: $\leq \pm 0.5$ dB
- Phase Balance: $\leq \pm 3$ deg
- VSWR: $\leq 1.50 : 1$
- Isolation: ≥ 20 dB
- Impedance: 50 OHMS
- Port Connectors: SMA-Female
- Power Handling: 1Watt

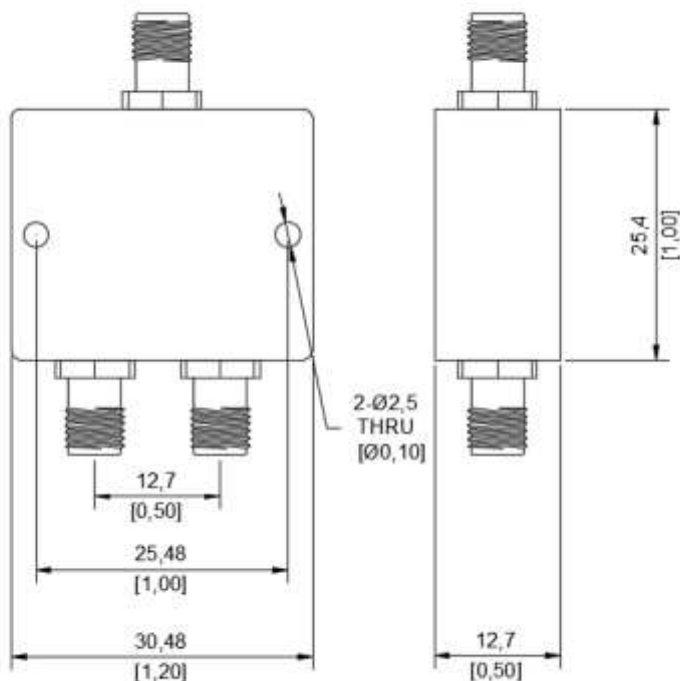

成都利德尔科技有限公司 ChengDu Leader Microwave Technology Co.,Ltd

电话: 028-65199117 传真: 028-65199116

<http://www.leader-mw.com> Leader-mw@hotmail.com

TEL: +86-28-65199117 FAX: +86-28-65199116

Add: 中国 成都市成华区华翰路 89 号 610000

No.89,Huahan Road, chenghua Zone Chengdu, Sichuan China Zip Code:610000